

营销热线 Marketing Hotline

- ☎ : +86 25 84677638
- 📱 : +86 153 5818 2650
- 📠 : +86 25 8679 2901
- ✉ : jackynie@wincoo.com.cn
- 👤 : whatsapp:+86 153 5818 2650
- 💬 : wechat:+86 189 1594 2901

Website:  
<http://wincoomachine.en.made-in-china.com;>  
<https://njwincoo.en.alibaba.com/>  
[www.wincoo.com.cn](http://www.wincoo.com.cn)

# Rotators and manipulator welding machines



**自动焊接中心** 是由焊接操作机、自动焊机和焊接滚轮架或焊接变位机配套组合而成，广泛地应用于锅炉、压力容器、石油石化、冶金建设、制冷设备、工程机械、船舶制造、风力发电等行业中各种焊缝及其它圆筒形构件的内外纵缝和环缝的焊接。

Automatic welding center consists of welding manipulator, automatic SAW machine and welding turning roll or welding positioner, which is widely used in industries as boiler, pressure vessel, chemical petroleum, metallurgical construction, refrigeration, construction machinery, shipbuilding, wind power, for inner and outer longitudinal welding and circumferential welding of various seams on cylindrical members.

## 可选配功能 Optional Functions

### 配置及特点:

本系列焊接操作机主要结构件采用大型数控设备压制成型，焊接后进行回火处理，经抛丸处理后油漆，具有结构合理，强度高，刚性好等特点，根据用户需要可配直线滚珠导轨。

整机为积木式结构，根据用户需求可进行使用范围及性能的扩展。

### Configuration and characteristic:

This series of welding manipulator is pressed into shape by means of large CNC equipment, tempered post welding, and painted after shot blasting, with advantages of reasonable structure, high strength and good rigidity. Also linear ball-bearing guideway can be selected according to customer requirement.

The entire machine is of fit-up structure, of which applications and performance can be expanded according to customer choice.



## 自动焊接中心 Automatic Welding Center



自动焊接中心  
Auto-welding center



重型焊接中心  
Heavy-duty welding center



精密自动焊接中心  
Precise Auto-welding center



小机头 (适用筒体最小直径400mm)  
Low profile head (min vessel diameter 400mm)

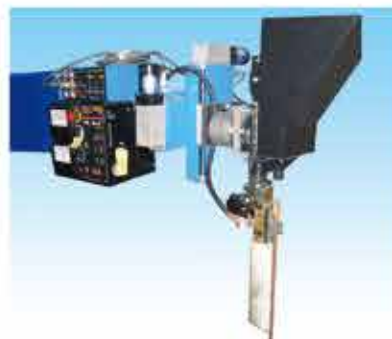

窄坡口焊接机头配焊缝跟踪  
Narrow groove welding head with weld seam tracker



带极堆焊系统  
Cladding nozzle system



三维自动跟踪  
Three-dimension auto-tracking monitoring system



自动弧长控制  
Auto-tracking of welding arc



带极堆焊焊接中心  
Strip Surfacing Welding System





**焊接操作机** 具有结构先进，功能齐全，操作方便等特点，对提高焊接质量起了可靠的保证作用。

根据横臂前端的承载重量、有效伸缩、升降行程，规格型号可分为轻型、标准型、重型、超重型；结构形式有固定式、固定带回转式、移动带回转式三种。

The welding manipulator is advance structure design, multi-functions and easy operation. Then increasing production capacity and assure the quality.

The welding manipulator could be divided into light, standard type, heavy, and super-heavy according to weight-bearing, effectively stretching and up/down stroke.

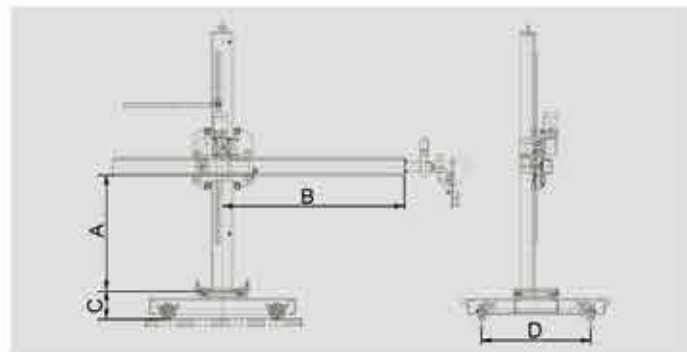

LHQ (轻型) 系列 LHQ(light) series

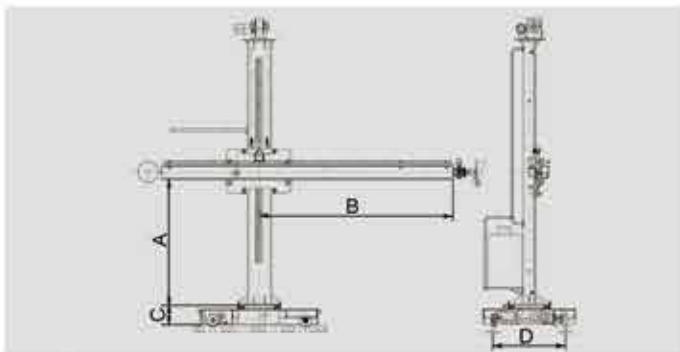

LHJ (中型) 系列 LHJ (medium) series

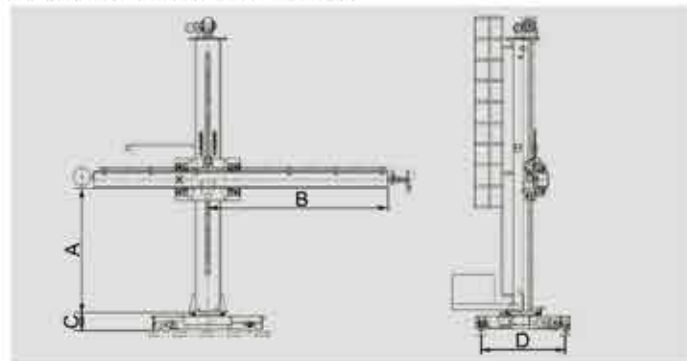

NLH (重型) 系列 NLH (heavy) series

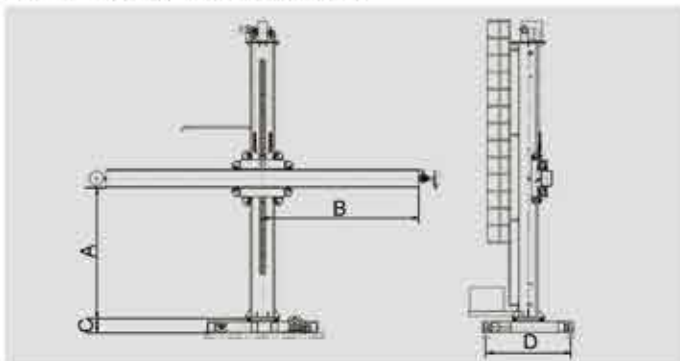

LHW (超重型) 系列 LHW (super-heavy) series

### 主要技术参数 Main Technical Parameters

规格型号 Type	LHQ (轻型 Light)	LHJ (中型 Medium)	NLH (重型 Heavy)	LHW (超重型 Super-heavy)
横臂立柱矩形导轨宽度 The rectangular guiding rail width of column and boom(mm)	25	35	60	75
横臂升降行程 Lifting stroke(mm)	1-3	2-5	2-8	2-13
横臂伸缩行程 Retracting stroke(mm)	1-3.5	2-5	2-8	4-12
升降速度 Lifting speed(mm/min)	1200	600	800	800
横臂下沿离立柱底板最小距离(A) Min. height under boom(A)(mm)	300	400	450	600
立柱中心到横臂前缘最小距离(B) Min. distance from column center to the front end of the boom(mm)	500	1000	1000	1000
伸缩速度 Retracting speed(mm/min)	100-1500	100-1500	100-1500	100-1500
立柱回转 Column revolving	角度 Angle(°)	±180	±180	±180
	速度 Speed(rpm)	手动 By manual	0.11/手动By manual	0.10/手动By manual
台车行走速度 Trolley traveling speed(mm/min)	手动推动 Traveling by manual	2000	2000	1000
台车高度(C) Height of trolley(C) (mm)	300	440	440	440
台车轨距(D) Span of trolley rail(D) (mm)	1200	1500	2000	2500

\* 注：具体参数要求根据用户要求来确定。  
Note: The parameters determined according to the specific requirement of users.

### 焊接操作机系列

#### Welding Manipulator Series



6m×6m中型焊接操作机  
6m×6m medium-duty welding manipulator



批量生产的精密型焊接操作机（采用滚珠直线导轨）  
Precise welding manipulator in batch production (uses ball bearing linear guide rail)



6m×5m重型焊接操作机（配林肯机头）  
6m×5m heavy-duty welding manipulator(with LINCOLN head)



10m×7m超重型焊接操作机（带载人操作平台）  
10m×7m super-heavy type welding manipulator(with manned platform)



8m×7m超重型焊接操作机（带载人操作平台）  
8m×7m super-heavy type welding manipulator(with manned platform)



### 悬挂式焊接平台 Suspenden Welding Platform

**HS系列悬挂式焊接平台**是我公司在吸取国外先进设备的优点，自行开发的新产品，先后为国内外多家用户单位设计制作。

该平台主要由底部行走装置、立柱、升降平台、顶部导向装置、检修爬梯及电气控制系统等组成，其特点是：

1、行走由上下两条导轨组成：底部行走装置配备下导轨，顶部导向装置配备上导轨，上导轨安装在车间的立柱上方，空间利用率高；

2、焊机放置在平台上，焊枪可在平台上移动；

3、平台额定承载能力大，可沿立柱上下升降；

4、平台作业范围大，与焊接滚轮架配套使用，主要应用于外环缝和外纵缝的焊接。

HS-Series Suspenden Welding Platform is the new product developed by ourselves on the basis of absorbing merits of advanced equipment from abroad. This kind of products has been adopted by many clients both from China and abroad.

This platform consists of the bottom traveling structure, column, platform, top guide structure, ladder and electrical system, the main features is as follows:

1. The traveling system consists of two rails at up-side and down-side: The traveling structure equipped with under rail, the guide structure at top has up rail. The up rail installed at the top of column in workshop, which will be max using of the space.

2. The welding machine sit on the platform, the welding torch could be moved on the platform.

3. The platform is heavy loading design, which could move up and down along the columns.

4. The working range of this platform is very big, and can work with welding rotators, used to welding the outer circumferential and longitudinal seam welding.



5m悬挂式焊接平台  
5m Suspenden welding platform



8m悬挂式焊接平台  
8m Suspenden welding platform

### 特殊焊接操作机 The Special Welding Manipulator



龙门式焊接操作机  
Gantry type welding manipulator



门架式焊接操作机  
Gantry type welding manipulator



5\*5 超重型操作机 (配宝利苏迪热丝TIG焊)  
5\*5 welding manipulator (Equipped with POLYSOUDE hot wire TIG welding)



双柱式龙门焊  
Twin column type gantry welding machine



10mx6m超重型焊架 (配伊萨ICE四丝埋弧焊)  
10mx6m welding manipulator (Equipped with ESAB ICE SAW)



## 自调式焊接滚轮架 Self-alignment Welding Turning-roll



自调式单驱动焊接滚轮架 Single-driving self-alignment welding turning-roll



自调式双驱动焊接滚轮架 Double-driving self-alignment welding turning-roll

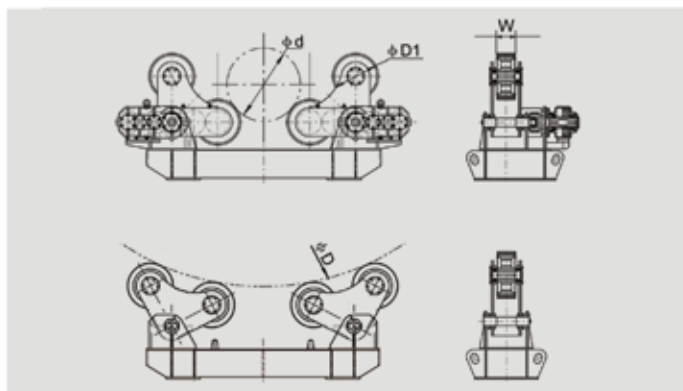
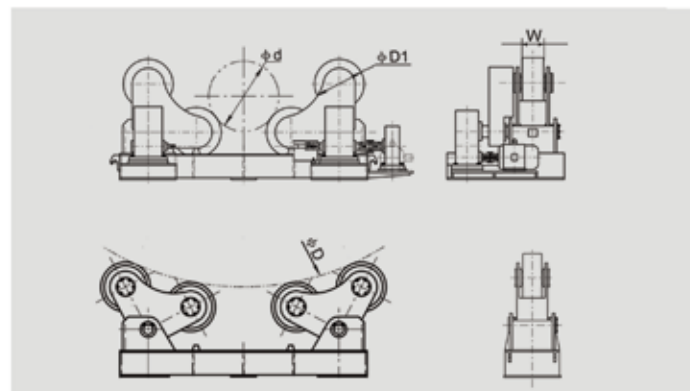

根据工件直径大小自动调节滚轮组的摆角，无须人工调节。聚氨酯滚轮，承载能力大，驱动能力强。根据驱动方式分为单驱动、双驱动两种形式。

本公司还可根据用户需要设计定制各种类型的滚轮架。

Tilt angle of rollerbed can be automatically adjusted as per diameters of workpiece, and no manual adjustment is needed. Polyurethane rollers have high bearing capacity and strong driving ability. According to driving mode, it could be divided into unilateral and bilateral driving.

We also can design the customize various types of the turning-rolls in accordance with the customer's requirement.

## 主要技术参数 Main Technical Parameters

规格型号 Type	HGZ-5	HGZ-10	HGZ-20	HGZ-40	HGZ-60	HGZ-80	HGZ-100	HGZ-150
最大承载重量 Max load weight(t)	5	10	20	40	60	80	100	150
聚氨酯轮 Polyurethane tire	直径D1 Diameter D1(mm)	250	300	350	400	450	500	500
	宽度W Width W(mm)	100	120	150	160	180	240	400
筒体直径 Cylinder D.	最小d Min. d(mm)	250	320	500	600	750	850	1000
	最大D Max. D(mm)	2500	3200	3800	4500	5000	5500	6300
滚轮线速度 Roller linear speed(m/h)	6-60	6-60	6-60	6-60	6-60	6-60	6-60	6-60
电机功率 Motor power	单驱动 Single driver(kw)	0.75	1.1	1.5	3	4	4	5.5
	双驱动 Dual-drive(kw)	/	/	/	2×1.5	2×2.2	2×3	2×4
调速方式 Way of setting	交流变频无级调速 AC frequency conversion stepless inverter speed regulation							

## 可调式焊接滚轮架 Adjustable Welding Turning-roll

采用预留螺孔或丝杆调节滚轮组中心距，适应工件直径变化。进口变频器无级调速，调速范围宽，精度高，启动力矩大。本公司还可根据用户需要设计定制各种类型的滚轮架。

Bolt holes are preformed to adjust the center to center spacing of roller group, in accordance with the diameter variations of workpiece. Stepless speed regulation of imported frequency converter is adopted, with a wide range of speed regulation, high precision and large start-up moment.

We also can design the customize various types of the turning-rolls in accordance with the customer's requirement.

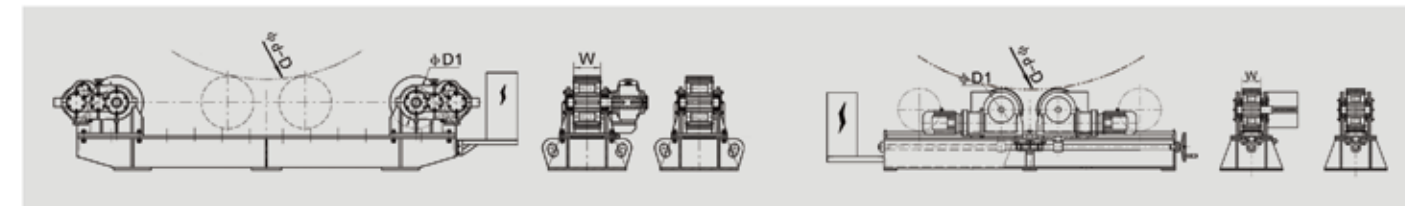

## 主要技术参数 Main Technical Parameters

规格型号 Type	HGK-2	HGK-5	HGK-10	HGK-20	HGK-40	HGK-60	HGK-80	HGK-100
最大承载重量 Max load weight(t)	2	5	10	20	40	60	80	100
聚氨酯轮 Polyurethane tire	直径D1 Diameter D1(mm)	200	250	300	350	400	450	500
	宽度W Width W(mm)	80	120	130	180	220	360	400
筒体直径 Cylinder D.	最小d Min. d(mm)	150	250	300	500	500	500	800
	最大D Max. D(mm)	2000	2800	3200	4500	5000	5000	6000
电机功率 Motor power(kw)	2×0.18	2×0.37	2×0.55	2×1.1	2×1.5	2×2.2	2×3	2×3
滚轮线速度 Roller linear speed(m/h)	6-60	6-60	6-60	6-60	6-60	6-60	6-60	6-60
调速方式 Way of setting	交流变频无级调速 AC frequency conversion stepless inverter speed regulation							
规格型号 Type	HGK-100	HGK-160	HGK-200	HGK-250	HGK-300	HGK-500	HGK-800	HGK-1200
最大承载重量 Max load weight(t)	100	160	200	250	300	500	800	1200
	直径D1 Diameter D2(mm)	500	600	700	700	800	800	900
	宽度 Width(mm)	200	200	250	250	300	350	400
	最小d Min. d(mm)	800	800	800	800	800	1000	1000
	最大D Max. D(mm)	6000	6000	6500	6500	6500	8000	8000
电机功率 Motor power(kw)	2×3	2×4	2×4	2×5.5	2×5.5	2×7.5	2×11	2×15
滚轮线速度 Roller linear speed(m/h)	6-60	6-60	6-60	6-60	6-60	6-60	6-60	6-60
调速方式 Way of setting	交流变频无级调速 AC frequency conversion stepless inverter speed regulation							



自调式焊接滚轮架  
Self-alignment Welding Turning-roll



顶升式焊接滚轮架  
Lifting assembly rotator



40t自调式焊接滚轮架  
40t Self-aligning rotator



200t自调双驱动焊接滚轮架  
200t double-driving self-alignment rotator



200吨自调式焊接滚轮架（聚氨酯轮）  
200t Self-aligning rotator (PU tyre)



300t焊接滚轮架  
300t welding rotator



60吨自调式滚轮架  
60t Self-aligning rotator

可调式焊接滚轮架  
Adjustable Welding Turning-roll



1000t焊接滚轮架  
1000t welding rotator



800吨丝杆可调式滚轮架  
800t leadscrew type welding rotator



1200吨防窜滚轮架  
1200t anti-drifting rotator



批量生产的1000吨滚轮架  
Batch produced 1000t conventional rotator



200t可调式焊接滚轮架（聚氨酯轮、电动行走）  
200t conventional rotator (PU type, motorized bogie)



600吨可调式滚轮架（钢胶结合轮）  
600t conventional rotator (Rubber+steel ring wheel)



特殊滚轮架系列  
The Special Turning-rolls Series

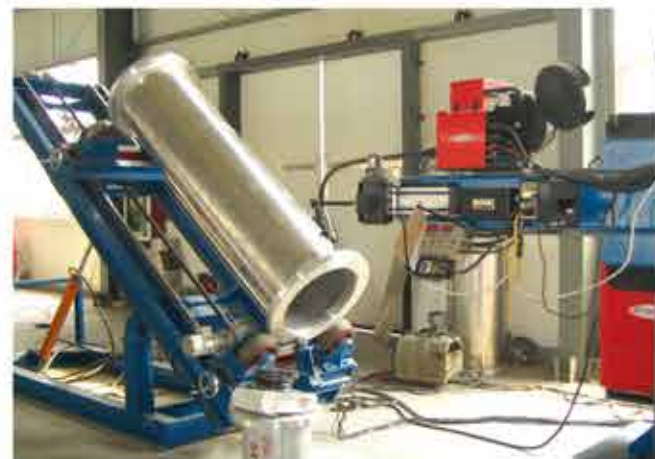

可倾斜式焊接滚轮架  
Slanting welding turning-roll



批量生产的窄轮滚轮架（锅炉厂专用）  
Turning-roll of narrow roll in batch production(specialized for boiler factory)

特殊滚轮架系列  
The Special Turning-rolls Series



500吨防窜滚轮架  
500t anti-drifting rotator



出口沙特的焊接滚轮架  
The welding turning-roll exported to Saudi Arabia



窄轮滚轮架  
Turning-roll with narrow roller



20t升降平移式滚轮架  
20t conventional rotator(Horizontal moving and elevating)



100t丝杆可调式滚轮架（带电动行走）  
100t conventional power control turning-roll(Motorized travelling)



500吨丝杆可调式滚轮架  
500t conventional power control turning-roll



500t自动平移防窜滚轮架  
500t automatic mobile anti-drift rotator



500t防窜滚轮架  
500t anti-drift rotator



批量生产的200t丝杆可调式滚轮架（聚氨酯轮）  
200t conventional power control turning-roll in batch production(polyurethane tire)



200t带行走焊接滚轮架（聚氨酯轮）  
200t mobile welding rotator(polyurethane tire)



## 装配滚轮架 Assembly Turning-rolls

装配式滚轮架主要用于容器的拼接、装配与焊接，可以使得客户大量节约为实现所需作业而付出时间和精力成本。

本公司可根据客户要求提供各种装配式滚轮架，这些滚轮架都是适用于额定负荷下的牵引和自对中心作业。

The Assembly turning-rolls are mainly used for the sitiching, assembling and welding vessels. These turning-rolls can make it possible for customers to achieve considerable savings of time and effort needed to pay operating costs.

We can provide Assembly Turning-Rolls according to the customers' requirements.



批量生产的500t装配滚轮架  
500t assembly turning-roll in batch production

## 装配滚轮架 Assembly Turning-rolls



可倾斜式装配滚轮架  
Slanting type fit-up rotator



顶升式装配滚轮架  
Lifting assembly rotator



800t丝杆可调式滚轮架  
800t conventional power control turning-roll



200t带行走焊接滚轮架（聚氨酯轮）  
200t mobile welding rotator (polyurethane tire)



500t自动平移防窜滚轮架  
500t automatic mobile anti-drift rotator



1600吨装配滚轮架  
1600t Assembly turning roll



自调式装配滚轮架  
Self-aligning fit-up rotator



100t顶升式装配滚轮架（丝杆可调式）  
100t lifting assembly turning-roll (conventional power control)



800t焊接滚轮架  
800t welding rotator



长轴滚轮架  
Long shaft rotator



## 风塔焊接生产线 Wind Tower Production Line

**风塔焊接生产线**是我公司根据国内外的成功设计经验和成熟的制造技术，自行开发研制的一条生产线。该生产线主要由数控切割机、铣边机、焊接操作机、焊接滚轮架、焊接系统等设备组成。

我公司已为国内外多个风力发电制造项目提供了大量设备，其中为上海振华港机提供的用于海上风力发电的单节塔筒重量为800t，为国内之最。

The Wind Tower Producing line is the welding system that we develop according to the successful design experience at home and abroad, and mature manufacturing technology. This system mainly consists of CNC Cutting Machine, Milling Edging Machine, Welding Manipulator, Welding Rotator and Welding System.

We have provided plenty of equipment for Wind Power Project in domestic and abroad market. The single set weight of wind tower made by Shanghai Zheng Hua that used for wind tower in the sea is 800t, which is the most heavy in domestic market.

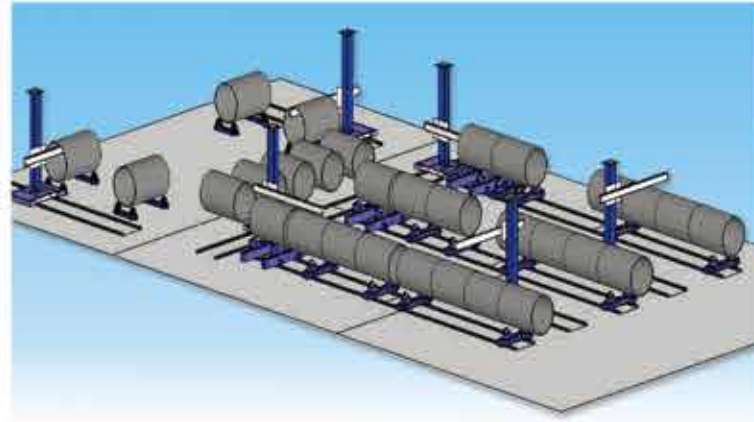

**1+1组对滚轮架**组对滚轮架专为筒体组对作业而设计，可以显著的减少组对作业中对筒体的校准及顶托所需的时间和劳力，从而节约成本，并能承受恶劣的作业环境。整机配置为一主三被，中间两个被动滚轮架带液压升降功能用以完成筒体的校准及对接工作。整机安装在一个主底座上，自成一体系。

1+1 Fit-up Rotator Fit up bed rollers are designed to suit cans staging application. This will enable the customer to save costs by dramatically reducing the time and effort required for aligning and jacking of cans. This system with its unique features provides the need for piping and vessel industries. The fastest system to assemble 1+1 sections. One set of Fit-up Rotator consist of one power and one idler roller bed 30T, four independently adjusted rollers to align the two sections with each other. The roller bed and the rollers are all mounted on one main frame.



**风塔生产成长线**风塔生产成长线专为风力筒体组对、拼接及环缝焊接作业而设计，可以显著在减少组对业中对筒体的校准、顶托及移动所需的时间和劳力，从而节约成本，并能承受恶劣的作业环境。整机配置主要由主动滚轮架、从动滚轮架、组对机构、组对从动滚轮架、液压系统及电气部分组成。

The growing line is mainly used in the welding of wind-power. As winder power towers are dozens of meters long, the fit-up work cannot be finished at one time, it required to pass through multiple cylinders. In order to change the traditional fit-up pattern with crane hoisting, to quickly loading workpieces and more convenient welding, we design the Growing and fit-up rotator. It has merits of advanced technology, reliable quality and simple operation and can improve the quality of jointing effectively.



## 风塔焊接生产线 Wind Tower Production Line



风塔焊接生产线  
Wind tower production line



法兰焊接  
Flange welding



1+1组对生产线  
1+1 fit-up rotator



100吨生产线滚轮架  
100t growing line rotator



500t超重海风电风塔组对生产线  
500t Super heavy duty offshore wind tower production line



塔筒喷砂、喷涂  
Tower sand blasting and painting



HBJ系列焊接变位机

HBJ Welding Positioner Series

焊接变位机一般由工作台回转机构和翻转机构组成，通过工作台的升降，翻转和回转使固定在工作台上的工件达到所需的焊接，装配角度，工作台回转为变频无级调速，可得到满意的焊接速度。

由于偏心距和重心距的原因，对工件较长和重心位置偏移较多的工件，应选择稍大一点的型号。标准型焊接变位机不能满足所有工件，选择时务需提供需加工工件的形状及重量，以及加工工艺。本公司会提供出合适的方案作参考。

Welding positioner is mainly composed of worktable revolving unit and tilting unit. By means of worktable elevation, work-piece fixed on the worktable can be placed to ideal position for welding and assembly. Speed of worktable revolving is controlled invariably and continuously with inverter, attaining satisfactory welding speed.

For the reason of eccentric-distance and gravity-center-distance, slightly higher model should be selected for longer work-piece and work-pieces of which gravity-center has greater offset. If standard welding positioner can not meet requirement for all work-pieces, be sure to offer us shape, weight and machining technology of work-piece, so we can furnish suitable proposal for your choice.

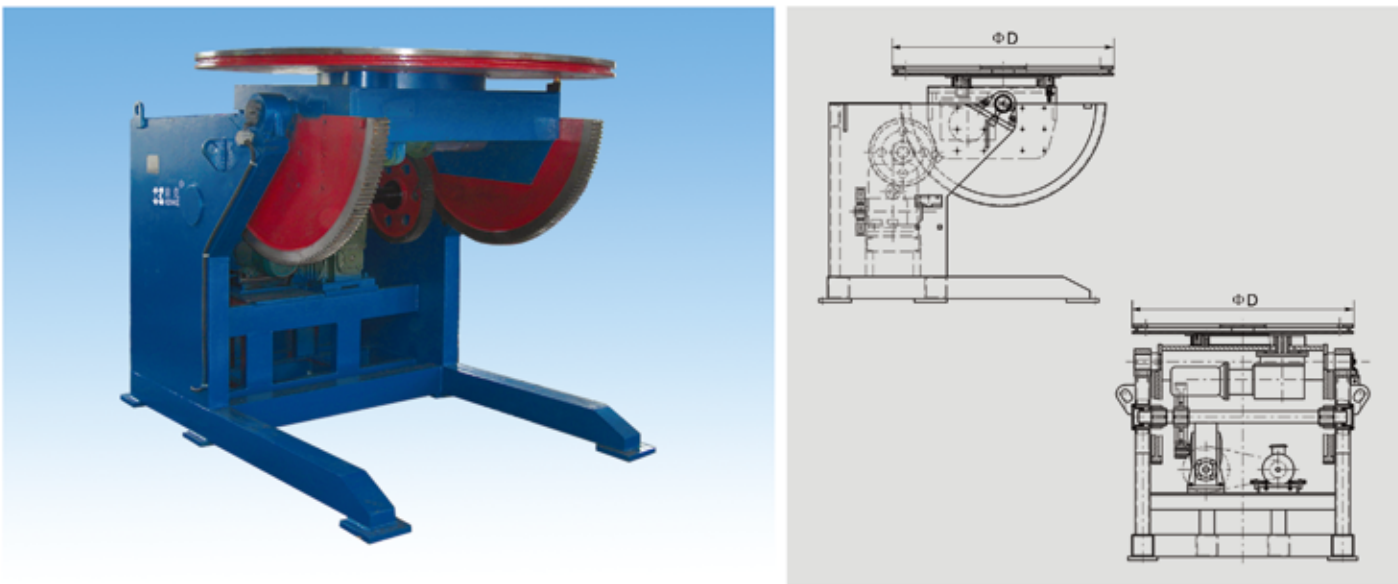

主要技术参数 Main Technical Parameters

规格型号 Type	额定承载 Rated Loading (kg)	回转速度 Rotation Speed (rpm)	翻转速度 Tilting Speed (rpm)	翻转角度 Tilting Angle (°)	工作台尺寸D Worktable Dia (mm)	回转电机功率 Rotation Power (kw)	翻转电机功率 Tilting Power (kw)	调速方式 Speed Regulation	最大偏心距 Max Eccentricity (mm)	最大重心距 Max Gravity (mm)
HBJ-01	100	0.4~4	手动 By manual	0~90	Φ 400	0.18	/	交流变频 无级调速 AC frequency conversion stepless speed regulation	100	200
HBJ-03	300	0.1~1	手动 By manual	0~90	Φ 600	0.18	/		150	200
HBJ-03	300	0.1~1	1	0~90	Φ 600	0.18	0.18		150	200
HBJ-06	600	0.05~0.5	0.4	0~90	Φ 1000	0.37	0.75		150	200
HBJ-12	1200	0.05~0.5	0.4	0~90	Φ 1200	0.75	1.1		200	250
HBJ-30	3000	0.05~0.5	0.2	0~135	Φ 1400	1.1	2.2		200	300
HBJ-50	5000	0.05~0.5	0.2	0~135	Φ 1500	1.5	3		200	300
HBJ-100	10000	0.05~0.5	0.2	0~135	Φ 2000	3	4		200	400
HBJ-150	15000	0.04~0.4	0.15	0~135	Φ 2200	4	7.5		200	500
HBJ-200	20000	0.04~0.4	0.15	-45~90	Φ 2500	5.5	11		200	600
HBJ-300	30000	0.03~0.3	0.15	-45~90	Φ 3000	5.5	15		200	650
HBJ-500	50000	0.02~0.2	0.06	-45~90	Φ 4000	11	18.5		200	800

\* 注：回转调速可采用直流或伺服调速，范围可达100倍。 Rotation speed regulation could be used DC or servo controlling, and the scope could be about 100 times.

HYD系列液压变位机

HYD Series Hydraulic Positioner

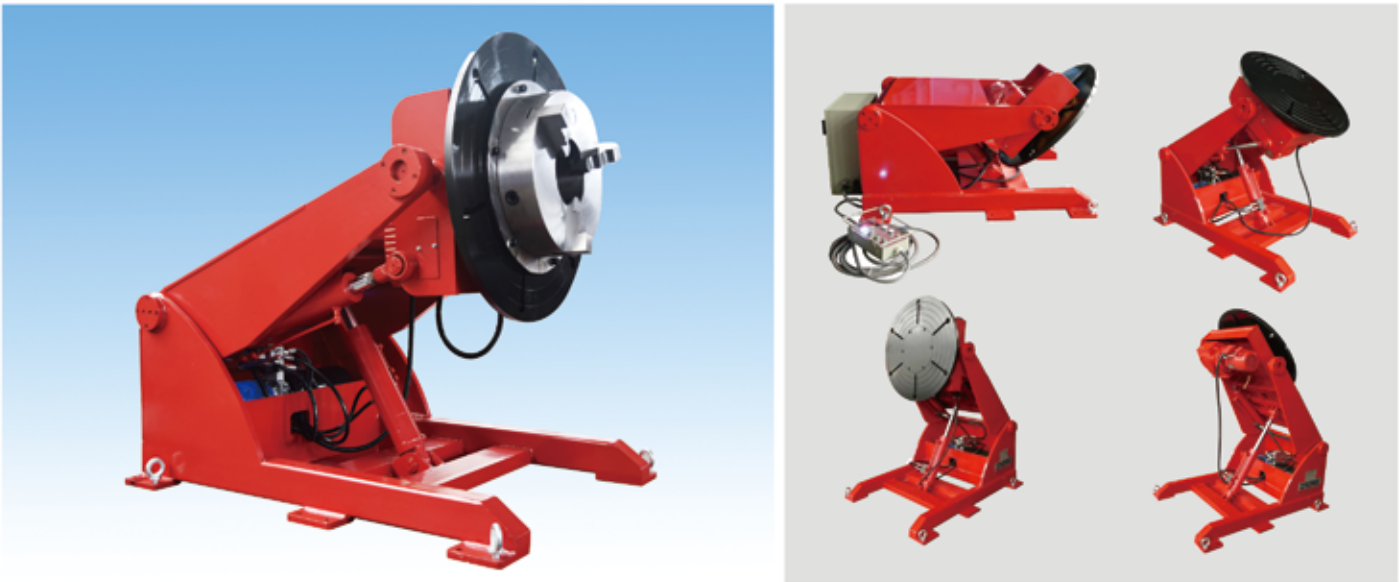

主要技术参数 Main Technical Parameters

Model	Max.load	Gravity (G)*	Eccentricity (E)*	Rotation speed	Tilting angle	Table diameter
HYD06	600 kg	250 mm	200 mm	0.1-1 rpm	0°-135°	900 mm
HYD10	1,000 kg	250 mm	200 mm	0.1-1 rpm	0°-135°	900 mm
HYD20	2,000 kg	250 mm	200 mm	0.1-1 rpm	0°-135°	1000 mm
HYD30	3,000 kg	300 mm	200 mm	0.05 – 0.5 rpm	0°-135°	1400 mm
HYD50	5,000 kg	300 mm	200 mm	0.05 – 0.5 rpm	0°-120°	1500 mm
HYD100	10,000 kg	400mm	200mm	0.05 – 0.5 rpm	0°-130°	2000 mm
HYD200	20,000 kg	600mm	250mm	0.05 – 0.5 rpm	0°-135°	2000 mm



### HJ系列焊接回转台 HJ Series Welding Turn Table

公司拥有各种自动焊接变位机。这些用途广泛的处理工具使焊接能够在最适宜的位置进行，从而使工作质量得到提高。变位机的承载能力在1吨到100吨之间。

HJ系列焊接回转台是满足工件旋转要求的最佳解决方案。旋转速度可以无极调节。

WINCOO has a comprehensive range of positioner for automatic welding. These very versatile handling tools enable welding to be carried out in the optimum positions to benefit the quality of the work. WINCOO's positioners are with capacities ranging for 1000 to 100,000kgs.

WINCOO HJ Series welding turning tables are the best solution to the problem of rotating demanding work pieces. Turning speed is all adjustable.

### 主要技术参数 Main Technical Parameters

型号 Model	承载 Max.load	偏心距 Eccentricity (E)*	回转速度 Rotation speed	工作台直径 Table diameter
HJ-10	1,000 kg	300 mm	0.1 - 1 rpm	1000 mm
HJ-30	3,000 kg	300 mm	0.1 - 1 rpm	1400 mm
HJ-50	5,000 kg	300 mm	0.1 - 1 rpm	1800 mm
HJ-100	10,000 kg	300 mm	0.05 - 0.5 rpm	2000 mm
HJ-300	30,000 kg	300 mm	0.05 - 0.5 rpm	2000 mm

### TWS系列焊接变位机 TWS Welding Positioner Series

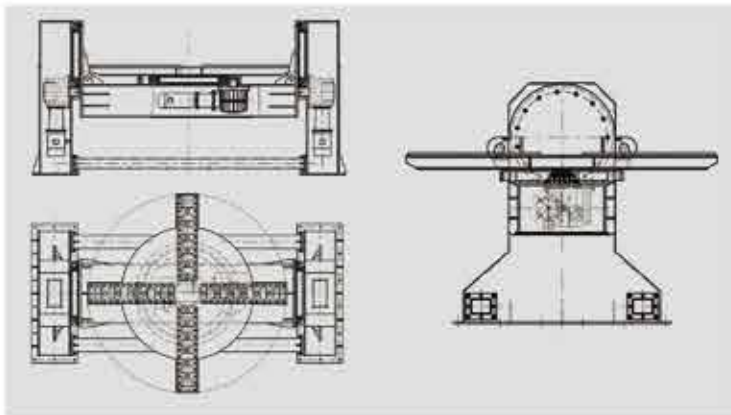

### 主要技术参数 Main Technical Parameters

规格型号 Turn	额定承载 Rated Loading (kg)	回转速度 Rotation Speed (rpm)	调速速度 Turning Speed (rpm)	回转角度 Turning Angle (°)	工作台尺寸D Worktable Dia. (mm)	回转电机功率 Rotation Power (kW)	调速电机功率 Turning Power (kW)	调速方式 Speed Regulation	最大偏心距 Max Eccentricity (mm)	最大重心距 Max Gravity (mm)
TWS-50	5000	0.05-0.5	0.2	0±90	φ2500	3	2×2.2	交流变频 无级调速 AC frequency conversion stepless speed regulation	200	600
TWS-100	10000	0.05-0.5	0.1	0±90	φ2500	4	2×3		200	600
TWS-200	20000	0.04-0.4	0.1	0±90	φ3000	5.5	2×5.5		200	1000
TWS-300	30000	0.03-0.3	0.1	0±90	φ3500	7.5	2×7.5		200	1500
TWS-500	50000	0.02-0.2	0.1	0±90	φ4000	11	2×11		200	2000
TWS-1000	100000	0.01-0.1	0.1	0±90	φ4000	18.5	2×15		200	2500

\* 注：回转调速可采用直流或伺服调速，范围可达100倍。 Rotation speed regulation could be used DC or servo controlling and the scope could be about 100 times.



120t焊接变位机  
120t welding positioner



5吨液压升降变位机  
5t Hydraulic Elevating Positioner



10吨升降式变位机  
10t Elevating Positioner

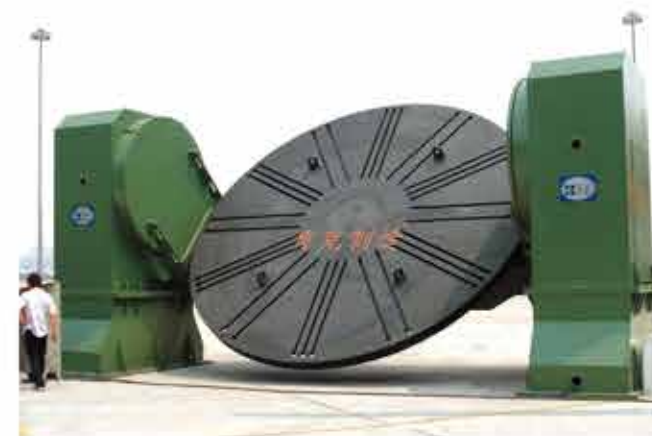

160t双座式焊接变位机  
160t double base-type welding positioner



40t双座式焊接变位机  
40t double base-type welding positioner



10吨焊接回转台  
10t Welding Turn Table



### 特殊变位机系列 The Special Positioner Series



20t焊接变位机  
20t welding positioner



滑台式焊接变位机  
Sliding platform welding positioner

### 特殊变位机系列 The Special Positioner Series



头尾升降双回转变位机  
Head and tail stocks elevating and double turning positioner



头尾升降双回转变位机  
Head and tail stocks elevating and double turning positioner



L型液压升降双回转变位机  
L-type hydraulic elevating and double turning positioner



L型升降双回转变位机  
L-type elevating and double turning positioner



头尾式双回转变位机  
Head and tail stocks and double turning positioner



特制焊接变位机  
The special welding positioner



齿圈式变位机  
Gear rack type welding positioner



滑台式焊接变位机  
Sliding platform welding positioner



50t回转平台  
50t rotating table



30t回转平台  
30t rotating table



### 特殊变位机系列 The Special Positioner Series



车架焊接变位机  
Frame welding positioner



牵引架焊接变位机  
Traction frame welding positioner



35吨焊接变位机  
35t welding positioner(Export to Saudi Arabia)



车架焊接变位机  
Frame welding positioner



中央盒焊接变位机  
The central box welding positioner



履带梁焊接变位机  
Track beam welding positioner

### 特殊变位机系列 The Special Positioner Series



C型焊接变位机  
C-type welding positioner



车架焊接变位机  
Frame welding positioner



L型升降双回转变位机  
L-type elevating and double turning positioner



驾驶室焊接变位机  
Cab welding positioner



20吨液压翻转架  
20t Hydraulic Tilting Positioner



半挂车车架焊接变位机  
Semi-Trailer frame welding positioner



### 双层油罐喷涂专机

#### Oil Tank Painting Machine

双层油罐喷涂专机由头尾式变位机、喷射小车、树脂纤维喷涂机等三部分组成。这台喷涂专机是用来给双层油罐表面的喷涂树脂纤维涂层。

这种机器能大大提高生产效率，降低生产工人的劳动强度，这是快速提高双层油罐喷涂效率的一种方法。

油罐喷涂专机是油罐喷涂的一种特殊的工作场所。该设计是根据油罐的重量和直径来设计的。

The oil tank painting machine consists of three parts: Head and Tail Stock Positioner, Spray Trolley, and Fiber Resin Spray Painting Machine. This oil tank painting machine is used to coat the fiber resin on the surface on the oil tank.

This kind of machine can greatly improve efficiency and reduce the labor intensity of workers in production, which is one of the ways to rapidly improve efficiency for coating the oil tank.

The oil tank painting machine is a kind of special working station for oil tank painting. The design is made according to the weight and diameter of the oil tank.

双层油罐喷涂专机示意图  
Sketch Drawing of Oil Tank Painting Machine

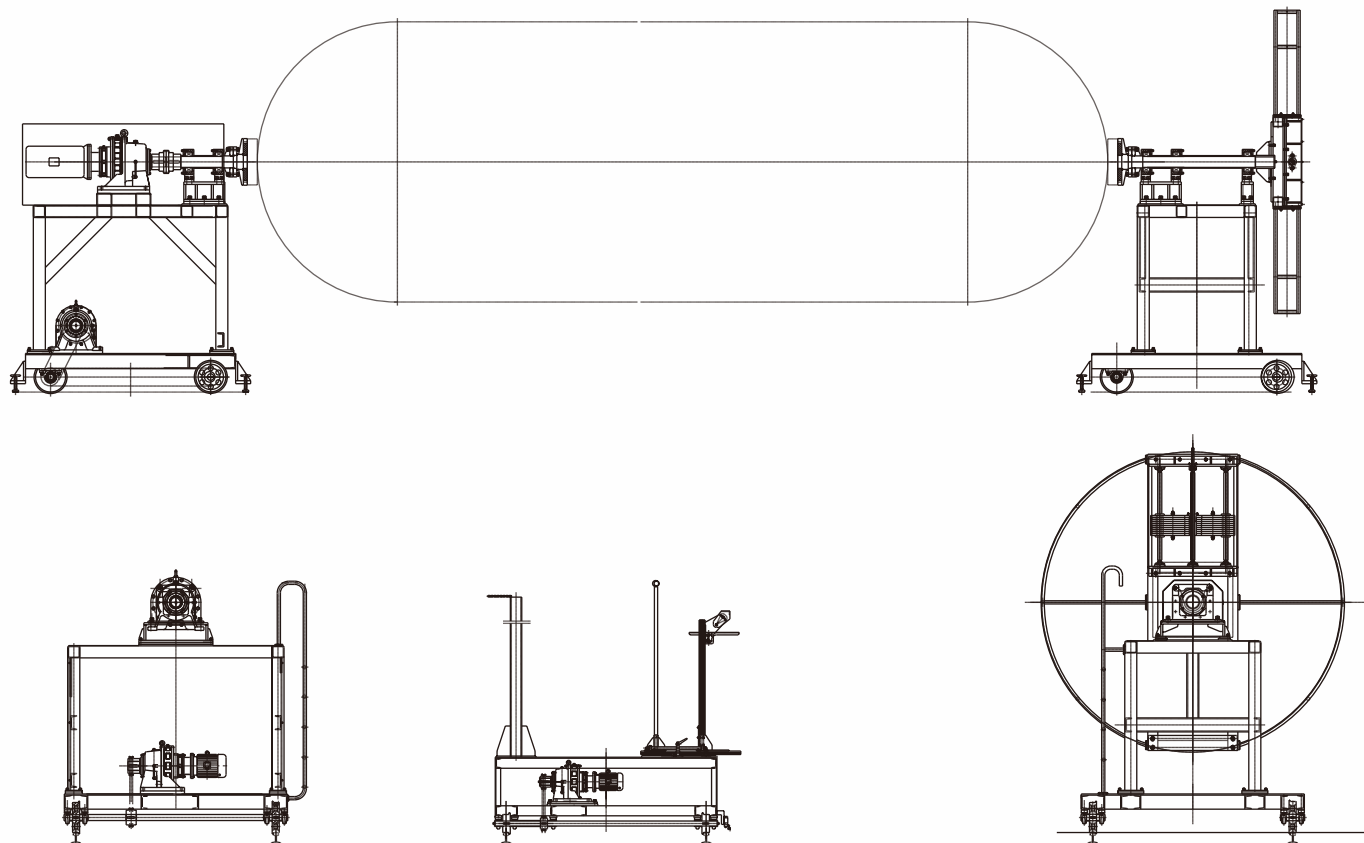



### RJG系列绕管机 RGJ Pipe Wrapping Machine

#### 绕管机组成及用途

##### Practical and Versatile of Pipe Wrapping Machine

绕管机由三部分组成：绕管主机、支撑托辊和绕管车。这种绕管机用于将钢管缠绕在换热器的中心管上。中心管的一端固定在绕管主机上，并由支撑托辊负载。绕管车上的钢管将在绕管主机旋转的同时缠绕在中心管上。

这种机器可以大大提高生产效率，降低工人的劳动强度，这是快速提高生产换热器效率的一种方法。

绕管机是一种特殊的换热器生产设备，设计是根据换热器的重量和直径来确定的。

The pipe wrapping machine consists of three parts: Pipe turning machine, supporting rotator and pipe wrapping machine. This pipe wrapping machine is used to wrap the steel tube on the center pipe of heat exchanger. One side of the center pipe fixed on the pipe turning machine, and load on the supporting rotator. The steel tube on the pipe wrapping machine will wrap on the pipe center while the turning machine rotating.

This kind of machine can greatly improve efficiency and reduce the labor intensity of workers in production, which is one of the ways to rapidly improve efficiency for producing the heat exchanger.

The pipe wrapping machine is a kind of special production center for heat exchanger. The design is made according to the weight and diameter of the heat exchanger.

#### 绕管机结构示意图 Sketch Drawing of Pipe Wrapping Machine

A视图  
View A

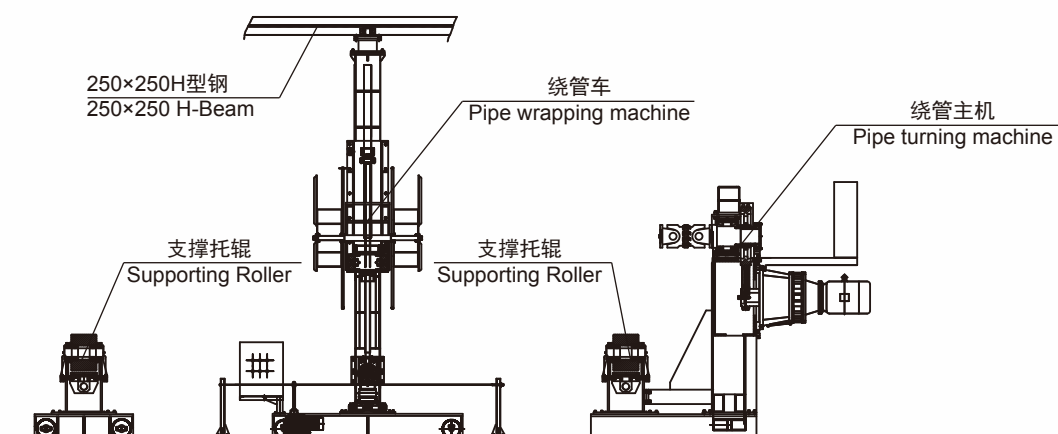

B视图  
View B

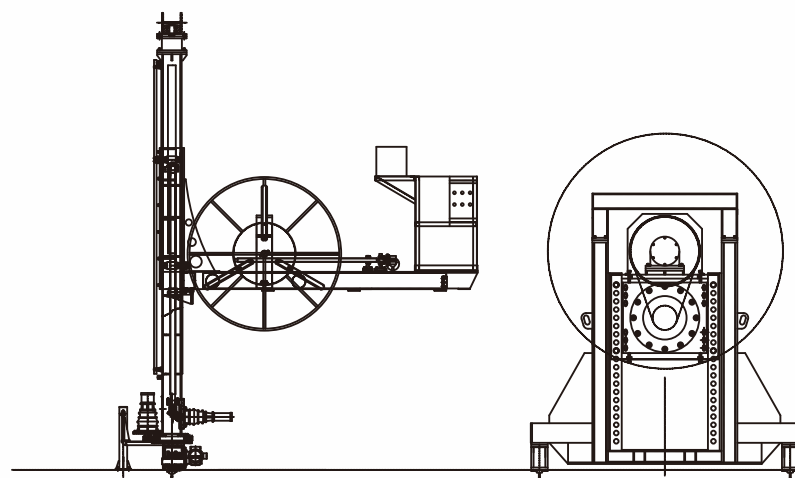

100吨绕管机主机  
100t Pipe Wrapping Machine



100吨绕管机  
100t Pipe Wrapping Machine



100吨绕管机  
100t Pipe Wrapping Machine



100吨绕管机  
100t Pipe Wrapping Machine



160吨绕管机  
160t Pipe Wrapping Machine



300吨绕管机  
300t Pipe Wrapping Machine